



An ALGECO SCOTSMAN Company

**WILLIAMS SCOTSMAN, INC**  
 171 Farmington Road  
 Summerville, SC 29483-5317  
 Phone: (843)873-5555 Ext. 43115  
 Fax: (843) 873-6633  
**Toll Free: 800-782-1500**  
 Thomas Mooney  
 Branch Sales Manager  
 tmmooney@willscot.com

**Quote Number:** 184055  
**Date:** November 14, 2011  
**Expiration:** December 14, 2011

**QUOTATION NO. 184055**

<b>Customer:</b> Palmetto Gun Club 1643 Savannah Hwy Charleston, South Carolina 29407	<b>Contact:</b> Matthew Gunning 1643 Savannah Hwy Charleston, SC 29407 Phone: (843) 875-7976 Fax: Email: wdnboat@earthlink.net	<b>Ship To:</b> RIDGEVILLE, SC 29472 US
--	--	---

**UNIT DESCRIPTION AND PRICING**

**36x24 Classroom (32x24 Box) CPX-13742**

PURCHASE PRICE	\$19,294.80	DELIVERY FREIGHT:	\$500.00
		INSTALLATION:	\$3,923.84

**OPTIONS**

QTY	DESCRIPTION	PRICE	EXTENDED
112	Vinyl skirting	\$8.00	\$896.00

**SUMMARY**

In addition to the above quoted prices, customer shall pay Williams Scotsman any local, state, or provincial federal and/or personal property tax or fees related to the equipment or its user. Physical Damage and commercial liability insurance coverage are required beginning on the date of delivery. **TOTAL CHARGES: \$24,614.64**

Williams Scotsman is not responsible for changes required by local code or building inspectors. Customer is responsible for locating and marking underground utilities prior to deliver. Quote assumes a level site with clear access.



8211 Town Center Drive  
Baltimore, Maryland 21236-5997

800.782.1500

www.willscot.com

# CL3624

CLASSROOM

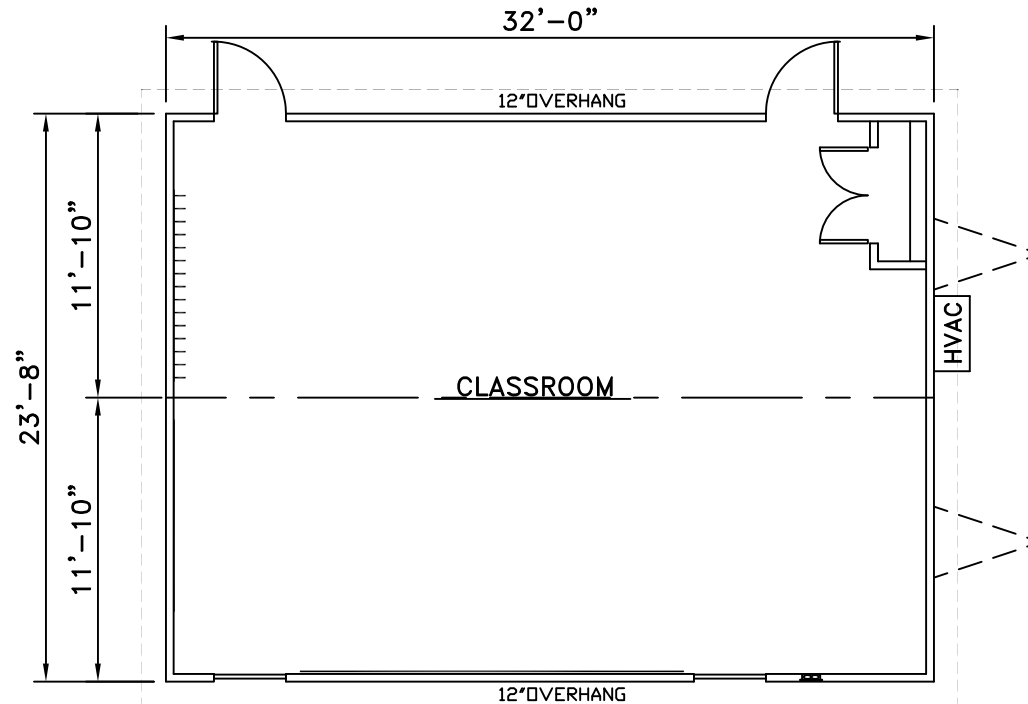

## Specifications

### Size

- 36' Long (including hitch)
- 32' Box size
- 24' Wide nominal
- 8' Ceiling height nominal

### Interior Finish

- Vinyl covered gyp walls
- Carpet floors
- Popcorn ceiling
- Open shells available

### Electric

- Fluorescent ceiling lights
- 110/240 volt single phase electric
- 100 AMP breaker panel

### Windows/Doors

- Vertical slider windows
- Std doors with standard locks

### Exterior Finish/Frame

- Hardipanel siding
- I-Beam outrigger frame
- Shingled roof

### Heating & Cooling

- Central HVAC unit
- Heat in A/C unit

Additional floor plans available. Floor plans and specifications may vary from those shown and are subject to in-stock availability.

<b>DWN BY:</b> MRW	<b>SERIAL#:</b> .	<b>REP:</b> .	<b>CAD FILE:</b> .
<b>SCALE:</b> 1/8"=1'	<b>DWG #</b> A-1	<b>DATE</b> 01/01/10	<b>REV#</b> 0

THE USE OF THIS DRAWING FOR ANY MEANS OTHER THAT INTENDED IS STRICTLY PROHIBITED WITHOUT THE PRIOR WRITTEN CONSENT OF AN AUTHORIZED WILLIAMS SCOTSMAN REPRESENTATIVE.

© 2010 Williams Scotsman, Inc. All Rights Reserved.